

FILED
GREENVILLE CO., S.C.
FEB 6 12 35 PM '85
DONNIE S. TANKERSLEY
R.M.C.

— ALLEN —

— MURRAY —

— MITCHELL —

— CEMETARY —

5.28 AC.

ROAD

ALLEN

707.04

S31-34W
159.54

S24-06W
99.83

S7-47W
127.87

S3-02E
90.37

S5-07E
104.30

S13-28W
92.18

S29-09W
100.08

S39-04W
290.78

N57-27E

N25-50W
394.16

N11-20W
219.71

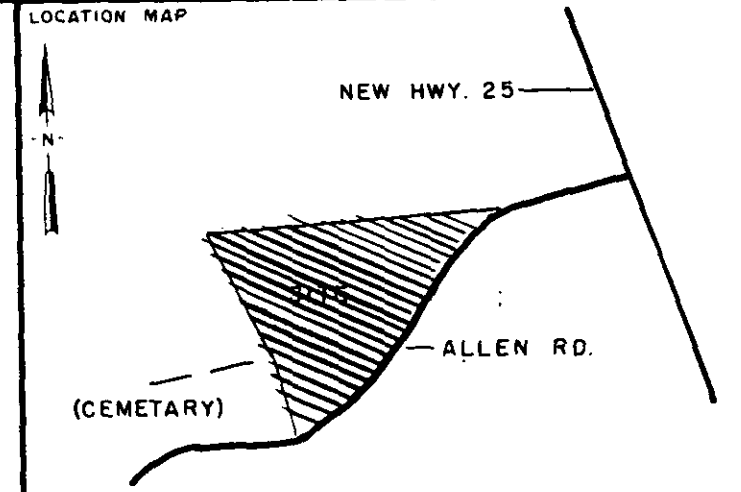
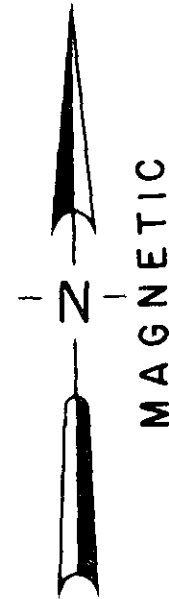

LEGEND	○ I.P. SET	◊ STONE
	● I.P. FOUND	⊙ R.R. SPIKE
	⊕ NAIL & CAP SET	⊛ NAIL & CAP FOUND

I hereby certify that the ratio of precision of the field survey is 1/500 as shown hereon and the area was determined by the coordinate method of area calculation.

I hereby certify that the measurements as shown on this plat are correct and that there are no encroachments or projections other than shown.

This property is subject to all easements, zoning ordinances and rights of way, of record or not of record, if any.

REF.— DEED BOOK 741 PAGE 9
BLK. BK. REF. 661.4 - 1 - PT. 10

PROPERTY OF
ELLA LOUISE ALLEN

SURVEYED FOR *Sharon A. Hawthorne*
SHARON A. HAWTHORNE

GREENVILLE COUNTY SOUTH CAROLINA
1"=100'
SCALE 100' 0 100' 200'
FEET

DRAWN	CHECK	DATE	JOB NO.
W. C. H.	T. D. L.	1 / 2 / 1985	1748 - 156

LINDSEY & ASSOCIATES
HWY. 253 RT. 1, TAYLORS S.C. 29687
LAND & HYDROGRAPHIC SURVEYORS

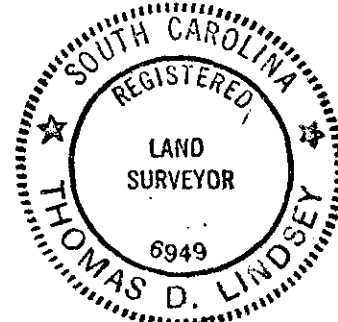

Thomas D. Lindsey
SIGNATURE

23245 ✓

1/4/85
DATE

THE PRINT MACHINE, INC. NS3413

MICROFILMED